

## Manual doweling template

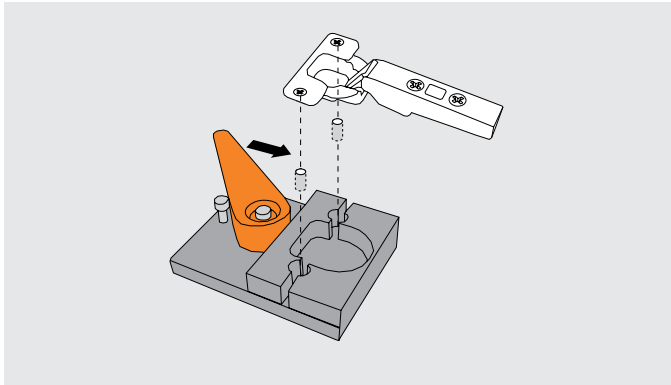

## Using the manual doweling template



- Template for manually attaching/removing dowels for CLIP top, CLIP, COMPACT and MODUL hinges
- Can be mounted to a work surface for stability
- Works for all Blum hinge and dowel combinations

Part no.

Manual doweling template

69.3600

### To remove dowels:

- With the lever in the open position insert hinge with dowels
- Secure hinge by turning orange lever
- Use a POZI driver or drill with POZI bit to remove dowel screws
- Release lever and remove hinge and dowels

### To attach dowels:

- With the lever in the open position insert dowels
- Secure dowels by turning orange lever
- Place hinge in the template
- Use a POZI driver or drill with POZI bit to insert dowel screws
- Release lever and remove hinge and dowels